

INFORMATION

asecos®

Comparison Of Safety Storage Cabinets For Flammables





Today flammables are used in most laboratory and industrial environments. Storing these materials improperly poses great risk for people and property.

While there is a large variety of storage cabinets for flammables available on the market, it is often a challenge for the users to select the appropriate product for their particular application or situation.

The following comparison is intended to help understanding the advantages and disadvantages of the different standards and aid in making the right decision for a safer workplace.

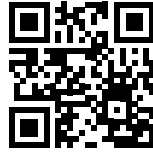

Watch the video on:
YouTube/asecosChannel

OVERVIEW

Storage of flammables

Insulation

Certification

Fire resistance (Minutes)

Disaster risk

*Legal consequences and
personal liability*



NOT SUITABLE
Safety containers mandatory

NO INSULATION

NONE



VERY HIGH



NO SAFETY



SUITABLE
Safety containers recommended

AIR INSULATION

THIRD PARTY CERTIFICATION
(FM 6050, UL 1275)

10

MEDIUM



SUITABLE
NO RESTRICTIONS

FIRE RESISTANT BOARDS

EN 14470-1

30

LOW

90

NONE

EN GS FM



MAXIMUM SAFETY

PROTECTION/MIN



STRUCTURE

Single-walled sheet steel

TECHNOLOGY

OBSOLETE



SAFETY ASPECTS

1	<i>Sealed door gaps</i>	X NO
2	<i>Self-closing doors</i>	X NO
3	<i>Insulation</i>	X NO
4	<i>Defined air flow</i>	X NO
5	<i>Similar fire performance as a store room</i>	X NO
6	<i>Maximum flexibility when choosing point of use</i>	X NO

YOUR SAFETY CHECKLIST

1. Type of building

NONE

2. Location

NONE

3. Evacuation time

0 minutes fire resistance gives no chance at all

- to evacuate the building
- for rescue forces to enter the building

4. Legal consequences

NO PROPERTY INSURANCE

- Unlimited personal liability

ADDITIONAL POINTS TO CONSIDER

**DO NOT USE
SUCH CABINETS
FOR STORING FLAMMABLES**



PROTECTION/MIN

10

STRUCTURE

Double-walled sheet steel
third party certified

TECHNOLOGY

BASIC



SAFETY ASPECTS

- | | | |
|---|--------------|--|
| 1 Sealed door gaps | X NO | |
| 2 Self-closing doors | ✓ YES | • Either permanent self-closing or self-closing in case of fire in combination with door holding mechanism |
| 3 Insulation | ✓ YES | • Air insulation |
| 4 Defined air flow | X NO | |
| 5 Similar fire performance as a store room | X NO | |
| 6 Maximum flexibility when choosing point of use | X NO | |

YOUR SAFETY CHECKLIST

1. Type of building

SMALLER / MIDSIZE

- Production facilities
- Factory buildings
- Shop floors

2. Location

GROUND FLOOR

- Easy to escape

3. Evacuation time

10 minutes fire resistance gives

- little time to evacuate the building
- no time for rescue forces to enter the building

4. Legal consequences

ONLY SOME **PROPERTY** **INSURANCES**

- Personal liability

ADDITIONAL POINTS TO CONSIDER

- | | |
|---|-----------------------------------|
| + Minor quantities | + Fire department close by |
| + Safety cans highly recommended | + Sprinkler system |

PROTECTION/MIN

30

SAFETY ASPECTS

1 *Sealed door gaps* ✓ YES

2 *Self-closing doors* ✓ YES

3 *Insulation* ✓ YES

4 *Defined air flow* ✓ YES

5 *Similar performance as a store room* ✗ NO

6 *Maximum flexibility when choosing point of use* ✗ NO

STRUCTURE

Fire-resistant boards

TECHNOLOGY

ADVANCED



YOUR SAFETY CHECKLIST

1. Type of building

MIDSIZE / LARGER

- Laboratories small and medium sized



2. Location

UP TO FIRST FLOOR

- Fire brigade close by



3. Evacuation time

30 minutes fire resistance
gives limited time to

- evacuate the building
- for rescue forces to enter the building



4. Legal consequences

ACCEPTED
BY MOST INSURANCE COMPANIES

- Reduced personal liability



ADDITIONAL POINTS TO CONSIDER

- + Larger quantities permissible
- + One cabinet per work room (recommended)

PROTECTION/MIN

90

SAFETY ASPECTS

1

Sealed door gaps

✓ YES

2

Self-closing doors

✓ YES

3

Insulation

✓ YES

4

Defined air flow

✓ YES

5

*Similar performance
as a store room*

✓ YES

6

*Maximum flexibility
when choosing point of use*

✓ YES

STRUCTURE

Highly-insulated
calcium sulfate boards

TECHNOLOGY

LATEST



YOUR SAFETY CHECKLIST

1. Type of building

ANY SIZE AND TYPE

- Open space laboratories
- High risk areas



2. Location

ANYWHERE

- High rises
- Remote areas



3. Evacuation time

90 minutes fire resistance gives sufficient time to

- evacuate the building
- enter the building for fire-fighting measures and rescue operations

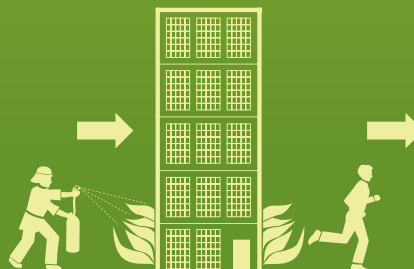

4. Legal consequences

FULL ACCEPTANCE BY INSURANCE COMPANIES

- Reduces personal liability as much as possible



ADDITIONAL POINTS TO CONSIDER

NONE





BE ON THE SAFE SIDE
ALWAYS CONSIDER:

1 Distance

2 Surroundings

3 Evacuation Times

4 Economic Impact





***Watch the Video:
Comparison Of
Safety Storage Cabinets
For Flammables***

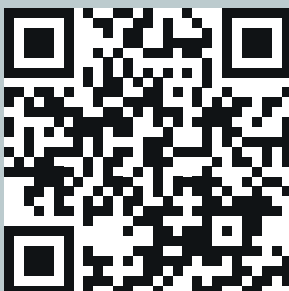

You **Tube**

[www.youtube.com/
asecoschannel](http://www.youtube.com/asecoschannel)



Source: WALDNER Laboreinrichtungen GmbH & Co.KG



Source: Endress+Hauser, Reinach



Source: Klinikum, Fulda



Source: Wesemann GmbH

www.asecos.global

asecos GmbH

Sicherheit und Umweltschutz
Weierfeldsiedlung 16-18
DE-63584 Gründau

☎ +49 6051 92200
✉ +49 6051 922010
@ info@asecos.com

Asecos BV

Veiligheid en milieubescherming
Tuinderij 15
NL-2451 GG Leimuiden

☎ +31 172 506476
✉ +31 172 506541
@ info@asecos.nl

asecos SARL

Sécurité et protection de l'environnement
1, rue Pierre Simon de Laplace
FR-57070 Metz

☎ +33 3 87 78 62 80
@ info@asecos.fr

asecos S.L.

Seguridad y Protección del
Medio Ambiente
CIM Valles, C/ Calderí S/N
Oficinas 75 a 77
ES-08130 - Santa Perpètua de Mogoda
Barcelona

☎ +34 935 745911
✉ +34 935 745912
@ info@asecos.es

asecos Ltd.

Safety and Environmental Protection
Profile House
Stores Road
Derby, Derbyshire
DE21 4BD

☎ +44 1332 415933
@ info@asecos.co.uk

asecos

Safety and Environmental Protection Inc.
19109 West Catawba Avenue, Suite 200
Cornelius, NC 28031
USA

☎ +1 704 8973820
✉ +49 6051 922010
@ info@asecos.com

asecos Schweiz AG

Sicherheit und Umweltschutz
Gewerbe Brunnmatt 5
CH-6264 Pfaffnau

☎ +41 62 754 04 57
✉ +41 62 754 04 58
@ info@asecos.ch

asecos AB

Säkerhet och miljöskydd
Skyttelgatan 23
753 42 Uppsala

☎ +46 18 34 95 55
@ info@asecos.se