

## Safety storage cabinets with wing or folding doors - Overview

### The Basic

#### Standard Safety.

Very smooth opening of the doors provides more convenience and safety when using the cabinets.

The flexible interior equipment provides a customised storage solution for most situations.



Approved storage of hazardous materials at the workplace in accordance with EN 14470-1 (Type 30)



**Model F30.197.120**  
Cabinet width 1200 mm  
with shelves (page 42)



**Model F30.197.60**  
Cabinet width 600 mm  
with shelves (page 43)



**Model F30T197.120**  
Cabinet width 1200 mm  
with shelves (page 44)



**Model F30T197.60-G**  
Cabinet width 600 mm  
with shelves (page 45)

RAL 1004 RAL 7035

EN  CE



with restrictions



Type tested according to EN 14470-1 (Type 30).

## Safety storage cabinets with wing or folding doors - Detailed Description

### Cabinets with wing or folding doors

#### Function

- Smooth, air-damped door closing
- Minimal effort: door opening - easy and safe
- Door closing system outside the storage compartment: increased protection of moving and safety relevant components against corrosion

#### Wing doors

- 90° opening, interior of the cabinet completely visible

#### Folding doors

- Protrude 50 % less than wing doors

- 90° opening, interior of the cabinet completely visible
- Protection by vertical anti-trapping door strip

#### Door open arrest system

- Holds door open, eases the storage and removal inside the cabinet
- Your safety in the event of fire!
- Automatic closing of the door by an integrated thermal release system (fusible link)

#### Locking

- Cylinder locking

#### Bottom collecting sump

- Easy to remove
- With three-sided lip seal, safe collection of leakage

#### Shelves

- Height adjustable (32 mm increments)
- Secured against tilting

#### Base

- Integrated (100 mm ground clearance)
- Cabinet can be easily transported with a pallet truck, as the plinth has a removable faceplate

#### Accessories

- PE tray - protects shelves from corrosive materials
- Box for chemicals - separate storage of mildly aggressive chemicals
- Storage box - lockable, separate storage of hazardous materials



#### Locking mechanism

The cabinets are equipped with a cylinder lock on each door.



#### Extraction air inlet

The extraction air inlet is located on top of the cabinet.



#### Base

Easy and safe transportation of the cabinet with a pallet truck.



#### Protective panel

Maximum protection against finger injuries.



#### Door open arrest system

Convenient storage and removal. Safety in the event of fire due to integrated thermal release system, releasing the door at a defined temperature between 40 °C and 50 °C.



# «« Safety Storage Cabinets

## Safety storage cabinet with wing doors



**Model F30.197.120**  
with shelves



**Model F30.197.120-G**  
with shelves

## F30.197.120

### Approved storage of hazardous materials in workrooms

- Type tested in accordance with EN 14470-1 (30 minutes fire rated - Type 30)
- GS and CE conformity

### Technical data at a glance:

#### Cabinet

Dimensions W x D x H (mm):

**exterior approx. 1200 x 600 x 1970**

**interior approx. 1130 x 505 x 1710**

Weight: **approx. 280 kg**

Labelling in accordance with EN 14470-1

#### Wing doors

90° opening, interior of the cabinet completely visible;  
Smooth air damped door closing

#### Shelves

Height adjustable (32 mm increments)

Secured against tilting

Load capacity (evenly distributed load):

**approx. 75 kg**

Dimensions W x D x H (mm):

**approx. 1068 x 500 x 40**

#### Bottom collecting sump

Capacity: **approx. 60 ltr.**

#### Door open arrest system (optional)

Holds door open and eases the storage and removal inside the cabinet;

Automatic closing of doors and drawer by an integrated thermal release system (fusible link)

#### Ventilation

|                             |                   |    |
|-----------------------------|-------------------|----|
| Extraction air connection ø | mm                | 75 |
| Change of air (10 times)    | m <sup>3</sup> /h | 9  |
| Pressure drop               | Pa                | 4  |

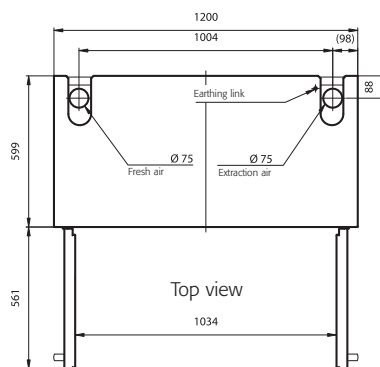

### Type 30 Safety storage cabinets with wing doors

| Model   | Material, colour               | recommended quantity | Order Code   |
|---|--------------------------------|----------------------|--------------|
| F30.197.120, 2 wing doors, excl. interior equipment   | light grey, RAL 7035           |                      | <b>20222</b> |
| F30.197.120-G, 2 wing doors, excl. interior equipment | warning yellow, RAL 1004       |                      | <b>20224</b> |
| Door open arrest system                               | with fusible link              | 1                    | <b>18332</b> |
| <b>Interior equipment</b>                             |                                |                      |              |
| Bottom collecting sump (V=60 ltr.)                    | sheet-steel, plastic laminated | 1                    | <b>9444</b>  |
| Perforated insert                                     | sheet-steel, plastic laminated | 1                    | <b>5536</b>  |
| Shelf   | sheet-steel, plastic laminated | 3                    | <b>9386</b>  |

Interior equipment in stainless steel available upon request.

## Safety storage cabinet with wing door



**Model F30.197.60-G**  
with shelves



**Model F30.197.60**  
with shelves

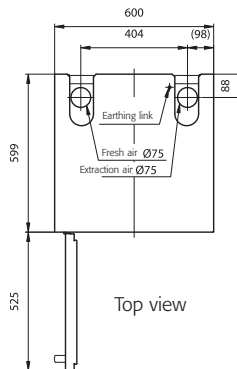

## F30.197.60

### Approved storage of hazardous materials in workrooms

- Type tested in accordance with EN 14470-1 (**30 minutes fire rated - Type 30**)
- GS and CE conformity

### Technical data at a glance:

#### Cabinet

Dimensions W x D x H (mm):

**exterior approx. 600 x 600 x 1970**

**interior approx. 530 x 505 x 1710**

Weight: **approx. 200 kg**

Labelling in accordance with **EN 14470-1**

#### Wing door

90° opening, interior of the cabinet completely visible;  
Smooth air damped door closing

#### Shelves

Height adjustable (32 mm increments)

Secured against tilting

Load capacity (evenly distributed load):

**approx. 75 kg**

Dimensions W x D x H (mm):

**approx. 468 x 500 x 40**

#### Bottom collecting sump

Capacity: **approx. 27 ltr.**

#### Door open arrest system (optional)

Holds door open and eases the storage and removal inside the cabinet;  
Automatic closing of doors and drawer by an integrated thermal release system (fusible link)

#### Ventilation

|                             |                   |    |
|-----------------------------|-------------------|----|
| Extraction air connection ø | mm                | 75 |
| Change of air (10 times)    | m <sup>3</sup> /h | 4  |
| Pressure drop               | Pa                | 2  |

### Type 30 Safety storage cabinets with wing doors

| Model  | Material, colour               | recommended quantity | Order Code   |
|--|--------------------------------|----------------------|--------------|
| <b>F30.197.60</b> , 1 wing door, left hand, excl. interior equipment     | light grey, RAL 7035           |                      | <b>20226</b> |
| <b>F30.197.60-R</b> , 1 wing door, right hand, excl. interior equipment  | light grey, RAL 7035           |                      | <b>20232</b> |
| <b>F30.197.60-G</b> , 1 wing door, left hand, excl. interior equipment   | warning yellow, RAL 1004       |                      | <b>20228</b> |
| <b>F30.197.60-GR</b> , 1 wing door, right hand, excl. interior equipment | warning yellow, RAL 1004       |                      | <b>20230</b> |
| Door open arrest system  | with fusible link              | 1                    | <b>18327</b> |
| <b>Interior equipment</b>  |                                |                      |              |
| Bottom collecting sump (V=27 ltr.)                                       | sheet-steel, plastic laminated | 1                    | <b>9445</b>  |
| Perforated insert  | sheet-steel, plastic laminated | 1                    | <b>5555</b>  |
| Shelf  | sheet-steel, plastic laminated | 3                    | <b>9432</b>  |

Interior equipment in stainless steel available upon request.

## Safety storage cabinet with folding doors



**Model F30T197.120**  
with shelves



**Model F30T197.120-G**  
with shelves

**Door open arrest system**  
➔ fitted as standard

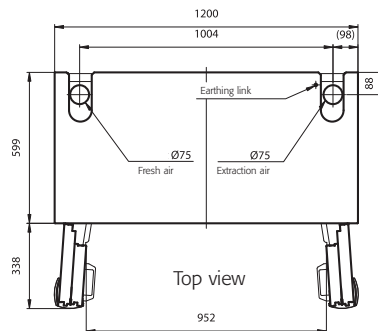

## F30T197.120

### Approved storage of hazardous materials in workrooms

- Type tested in accordance with EN 14470-1 (**30 minutes fire rated - Type 30**)
- GS and CE conformity

### Technical data at a glance:

#### Cabinet

Dimensions W x D x H (mm):

**exterior approx. 1200 x 600 x 1970**

**interior approx. 1130 x 505 x 1710**

Weight: **approx. 280 kg**

Labelling in accordance with **EN 14470-1**

#### Wing doors

90° opening, interior of the cabinet completely visible;  
Smooth air damped door closing

#### Shelves

Height adjustable (32 mm increments)  
Secured against tilting  
Load capacity (evenly distributed load): **approx. 75 kg**  
Dimensions W x D x H (mm): **approx. 1068 x 500 x 40**

#### Bottom collecting sump

Capacity: **approx. 60 ltr.**

#### Door open arrest system (standard)

Holds door open and eases the storage and removal inside the cabinet;  
Automatic closing of doors and drawer by an integrated thermal release system (fusible link)

#### Ventilation

|                             |                   |    |
|-----------------------------|-------------------|----|
| Extraction air connection ø | mm                | 75 |
| Change of air (10 times)    | m <sup>3</sup> /h | 9  |
| Pressure drop               | Pa                | 4  |

### Type 30 Safety storage cabinets with floding doors

| Model  | Material, colour               | recommended quantity | Order Code   |
|--|--------------------------------|----------------------|--------------|
| <b>F30T197.120</b> , 2 folding doors, excl. interior equipment   | light grey, RAL 7035           |                      | <b>20242</b> |
| <b>F30T197.120-G</b> , 2 folding doors, excl. interior equipment | warning yellow, RAL 1004       |                      | <b>20243</b> |
| <b>Interior equipment</b>  |                                |                      |              |
| Bottom collecting sump (V=60 ltr.)                               | sheet-steel, plastic laminated | 1                    | <b>9444</b>  |
| Perforated insert  | sheet-steel, plastic laminated | 1                    | <b>5536</b>  |
| Shelf  | sheet-steel, plastic laminated | 3                    | <b>9386</b>  |

Interior equipment in stainless steel available upon request.

## Safety storage cabinet with folding door



**Model F30T197.60-G**  
with shelves



**Model F30T197.60**  
with shelves

**Door open arrest system**  
➔ fitted as standard

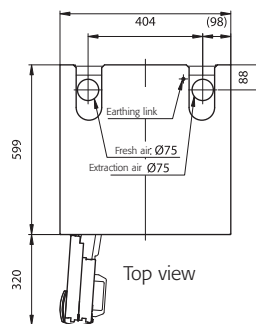

## F30T197.60

### Approved storage of hazardous materials in workrooms

- Type tested in accordance with EN 14470-1 (**30 minutes fire rated - Type 30**)
- GS and CE conformity

### Technical data at a glance:

#### Cabinet

Dimensions W x D x H (mm):

**exterior approx. 600 x 600 x 1970**

**interior approx. 530 x 505 x 1710**

Weight: **approx. 200 kg**

Labelling in accordance with **EN 14470-1**

#### Wing door

90° opening, interior of the cabinet completely visible;  
Smooth air damped door closing

#### Shelves

Height adjustable (32 mm increments)  
Secured against tilting  
Load capacity (evenly distributed load): **approx. 75 kg**  
Dimensions W x D x H (mm): **approx. 468 x 500 x 40**

#### Bottom collecting sump

Capacity: **approx. 27 ltr.**

#### Door open arrest system (standard)

Automatic closing of doors and drawer by an integrated thermal release system (fusible link)

#### Ventilation

|                             |                   |    |
|-----------------------------|-------------------|----|
| Extraction air connection ø | mm                | 75 |
| Change of air (10 times)    | m <sup>3</sup> /h | 4  |
| Pressure drop               | Pa                | 2  |

### Type 30 Safety storage cabinets with floding door

| Model   | Material, colour               | recommended quantity | Order Code   |
|---|--------------------------------|----------------------|--------------|
| <b>F30T197.60</b> , 1 folding door, left hand, excl. interior equipment     | light grey, RAL 7035           |                      | <b>20244</b> |
| <b>F30T197.60-R</b> , 1 folding door, right hand, excl. interior equipment  | light grey, RAL 7035           |                      | <b>20247</b> |
| <b>F30T197.60-G</b> , 1 folding door, left hand, excl. interior equipment   | warning yellow, RAL 1004       |                      | <b>20245</b> |
| <b>F30T197.60-GR</b> , 1 folding door, right hand, excl. interior equipment | warning yellow, RAL 1004       |                      | <b>20246</b> |
| <b>Interior equipment</b>   |                                |                      |              |
| Bottom collecting sump (V=27 ltr.)  | sheet-steel, plastic laminated | 1                    | <b>9445</b>  |
| Perforated insert   | sheet-steel, plastic laminated | 1                    | <b>5555</b>  |
| Shelf   | sheet-steel, plastic laminated | 3                    | <b>9432</b>  |

Interior equipment in stainless steel available upon request.