

Fire resistant drum cabinets

Storage of drums and bulky containers

In daily use the fire resistant drum cabinets guarantee optimum and safe storage and supply of flammables at the workplace.



90 minutes fire resistant drum cabinets for the storage of flammable liquids in 200 ltr. drums directly at the workplace

Operation

- Smooth and reliable closing of the doors
- High-quality slide bar door closer, optimal use of interior height, no door closer arm within the storage area
- Lifting height for the positioning of drums into the cabinet
Model VBF.221.108 = 460 mm
Model VBF.221.153 = 360 mm

Wing doors

- 100° opening, easy operation with a drum lifter or forklift truck

Your safety in the event of fire!

- Door open arrest system with an integrated thermal release system (fusible link), automatic closing of the doors

Earthing link (standard)

- Earthing inside at the rear panel
- Earthing link outside at the rear panel

Bottom collecting sump (standard)

- Removable
- Galvanised with grid
- Retention volume 220 ltr.

Shelf (optional)

- For small containers
- Load capacity (evenly distributed load): **75 kg**

Plinth (optional)

- Easy indoor transportation
- Steel profiles (100 x 100 mm) mounted underneath the cabinet with 100 mm ground clearance

Drum cabinet with rack system

Rack system consisting of:

- Completely installed rack incl. 3 shelves as storage levels
- Bottom collecting sump, galvanised steel (V=100 ltr.)



Slide-bar door closer

High-quality slide-bar door closer move the doors of the drum cabinets without effort. No inconvenient arm of the door closer inside the cabinet.



Bottom collecting sump

Sturdy, galvanised bottom collecting sump with galvanised grid. Safe and approved storage of 200 ltr. drums.



Base

Optionally the drum cabinets can be equipped with steel profiles. Safe transport with a forklift truck.



with restrictions

RAL 7035

EN



Type tested according to EN 14470-1 (Type 90).

Fire resistant drum cabinets - Overview



Model VBF.221.108 with additional plinth (page 68)



Model VBF.221.108 with additional shelf (page 68)



Model VBF.221.153 with additional shelf and plinth (page 69)



Model VBF.221.153 with rack system and two drum mounts (page 69)

Fire resistant drum cabinets



Model VBF.221.108 with additional shelf



Model VBF.221.108 with additional plinth

VBF.221.108

Safety Storage Cabinet

90 minutes fire resistance in accordance with **EN 14470-1**

(90 minutes fire rated - Type 90)

GS and CE conformity

Labelling in accordance with **EN 14470-1**

Technical data at a glance:

Cabinet

Dimensions W x D x H (mm):

exterior approx. 1105 x 1015 x 2225

(height with base approx. 2325 mm)

interior approx. 935 x 850 x 2030

Useable interior height: **approx. 1520 mm**

Lifting height for the positioning of drums into the cabinet: **approx. 460 mm**

Weight: **approx. 854 kg**

Shelf

Load capacity (evenly distributed load): **approx. 75 kg**

Dimensions W x D x H (mm):

approx. 920 x 490 x 25

Bottom collecting sump

Capacity: **approx. 220 ltr.**

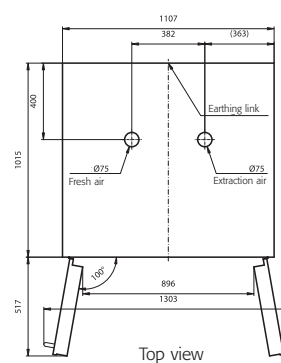

Ventilation

Extraction air connection \varnothing	mm	75
Change of air (10 times)	m ³ /h	12
Pressure drop	Pa	15

Type 90 drum cabinets

Model	Material, colour	recommended quantity	Order Code
VBF.221.108, Drum cabinet, wing doors	light grey, RAL 7035		21087
Interior equipment			
Shelf	sheet-steel, plastic laminated	1	10057
Accessories			
Plinth, height 100 mm	sheet-steel, plastic laminated	1	12823

Fire resistant drum cabinets



Model VBF.221.153 with additional shelf and base



Model VBF.221.153 with rack system and two drum mounts

VBF.221.153

Safety Storage Cabinet

90 minutes fire resistance in accordance with EN 14470-1

(90 minutes fire rated - Type 90)

GS and CE conformity

Labelling in accordance with EN 14470-1

Technical data at a glance:

Cabinet

Dimensions W x D x H (mm):

exterior approx. 1555 x 1015 x 2225

(height with base approx.: ca. 2325 mm)

interior approx. 1385 x 850 x 2030

- Useable interior height:

approx. 1620 mm

- Lifting height for the positioning of drums into the cabinet :

approx. 360 mm

- Weight: **approx. 1148 kg**

Shelf

- Load capacity (evenly distributed load): **approx. 75 kg**

- Dimensions W x D x H (mm):

approx. 1340 x 490 x 25

Bottom collecting sump

Capacity: **approx. 220 ltr.**

Rack system

- Rack dimensions W x D x H (mm):

approx. 1355 x 600 x 1820

- Total load capacity of the rack:

approx. 1300 kg

- Load capacity (evenly distributed load) per shelf: **approx. 200 kg**

- Bottom collecting sump, galvanised steel (V=100 ltr.)

Ventilation

Extraction air connection ø	mm	75
Change of air (10 times)	m ³ /h	19
Pressure drop	Pa	15

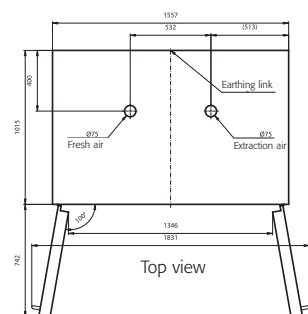

Type 90 drum cabinets

Model	Material, colour	recommended quantity	Order Code
VBF.221.153, Drum cabinet, wing doors	light grey, RAL 7035		21089
Interior equipment			
Shelf	sheet-steel, plastic laminated	1	10058
Interior equipment (optional)			
Rack system with 4 shelves and bottom collecting sump (V=100 ltr.)	galvanised steel		11184
Accessories			
Plinth, height 100 mm	sheet-steel, plastic laminated	1	11960
Drum mount	galvanised steel, for one 60 ltr. drum		2560